



UNIVERSITY OF NORTH DAKOTA
ATHLETICS SPACE INVENTORY /
MASTER PLANNING

ICON

WWW.ICONARCHITECTS.COM

JOB NO. 15-103 | AUGUST 23, 2018



EXECUTIVE SUMMARY

INTRODUCTION & GOALS

This Athletics Facilities Master Plan is intended to bring a current perspective and update to past Master Plans developed for the University and Athletics Department.

This Master Plan documents the following:

- Future planning process
- Key strengths of the athletic department facilities
- Current and future facility needs
- Needs of individual sports @ UND
- Long term strategic goals

UND Athletics wishes to elevate the game day experiences for all its 17 sports. It strives to ensure the venues and sports teams alike, are the top quality in its conference and division throughout the county. Fans, students, and Alumni of the University of North Dakota should feel this level of quality at every glimpse.

The Athletic Facilities Master Plan shall become a cohesive part of the overall Master Plan for the University of North Dakota. The University's commitment to Athletics is as evident in its athletics' facilities as it is campus wide.

PROCESS

A series of face to face meetings has been completed with the University's Facilities leaders to understand the goals and inventory of existing facilities, while considering future campus wide impacts and needs of the athletic department as well.

Additionally, Athletic Department leadership provided direction and input on all of its sports to develop a comprehensive plan for the future of the 17 sports in the department.

The Process consisted of the following steps:

- Review and discussion on existing facilities.
- Review of Hyslop athletic uses and functions needed including in depth space study and building utilization modeling.
- Programming on Master Plan Athletic Facility needs and spatial requirements.
- Review of individual sports needs and spatial requirements
- Develop Athletic Department needs and priorities
- Refinement and Recommendations to the Master Plan



FIGHTING HAWKS

MENS
WOMENS



MEN'S SPORTS	WOMEN'S SPORTS
Basketball	Basketball
Cross Country	Cross Country
Football	Golf
Golf	Soccer
Hockey	Softball
Tennis	Tennis
Track & Field - Indoor	Track & Field - Indoor
Track & Field - Outdoor	Track & Field - Outdoor
	Volleyball



UNIVERSITY AVENUE

COLUMBIA ROAD

LEGEND

1 HIGH PERFORMANCE CENTER PHASE II - PROPOSED

- Weight room and strength training area with coaching and instruction.
- Nutrition center and fueling stations
- Training room facilities
- Sports Medicine - rehabilitation and orthopedics spaces.
- Academic and tutoring center
- Track and field locker rooms for men and women
- Cross country locker rooms for men and women
- Softball locker rooms
- Golf lockers, simulators, and green space
- Football locker room facility
- Athletic Administration offices
- Hall of history displays
- Restroom facilities and other support spaces.

2 ATHLETIC ADMINISTRATION/ ROTC / PUBLIC PRIVATE PARTNERSHIP

3 HYSLOP SPORTS CENTER

4 MEMORIAL STADIUM FIELD

5 THROWING & FIELD EVENTS

6 CENTER FOR ATHLETIC EXCELLENCE - FUTURE

7 CLEAR SPAN ATHLETIC BUILDING (190' X 380')

8 SOFTBALL COMPLEX

A FOOTBALL

B MENS TRACK

C WOMENS TRACK

D MENS CROSS COUNTRY

E WOMENS CROSS COUNTRY

F WOMENS SOFTBALL

G MENS GOLF

H WOMENS GOLF

3
VACATED

2

6

4

1

EXISTING
HIGH PERFORMANCE
CENTER

TUNNEL
CONNECTION

5

7

8

UND TURF SPORTS - MASTERPLAN #1



LEGEND

1 HIGH PERFORMANCE CENTER PHASE II - PROPOSED

- Weight room and strength training area with coaching and instruction.
- Nutrition center and fueling stations
- Training room facilities
- Sports Medicine - rehabilitation and orthopedics spaces.
- Academic and tutoring center
- Track and field locker rooms for men and women
- Cross country locker rooms for men and women
- Softball locker rooms
- Golf lockers, simulators, and green space
- Football locker room facility
- Athletic Administration offices
- Hall of history displays
- Restroom facilities and other support spaces.

2 ATHLETIC ADMINISTRATION/ ROTC / PUBLIC PRIVATE PARTNERSHIP

3 HYSLOP SPORTS CENTER

4 MEMORIAL STADIUM FIELD

5 THROWING & FIELD EVENTS

6 CENTER FOR ATHLETIC EXCELLENCE - FUTURE

7 CLEAR SPAN ATHLETIC BUILDING (190' X 380')

- A** FOOTBALL
- B** MENS TRACK
- C** WOMENS TRACK
- D** MENS CROSS COUNTRY
- E** WOMENS CROSS COUNTRY
- F** WOMENS SOFTBALL
- G** MENS GOLF
- H** WOMENS GOLF

3
VACATED

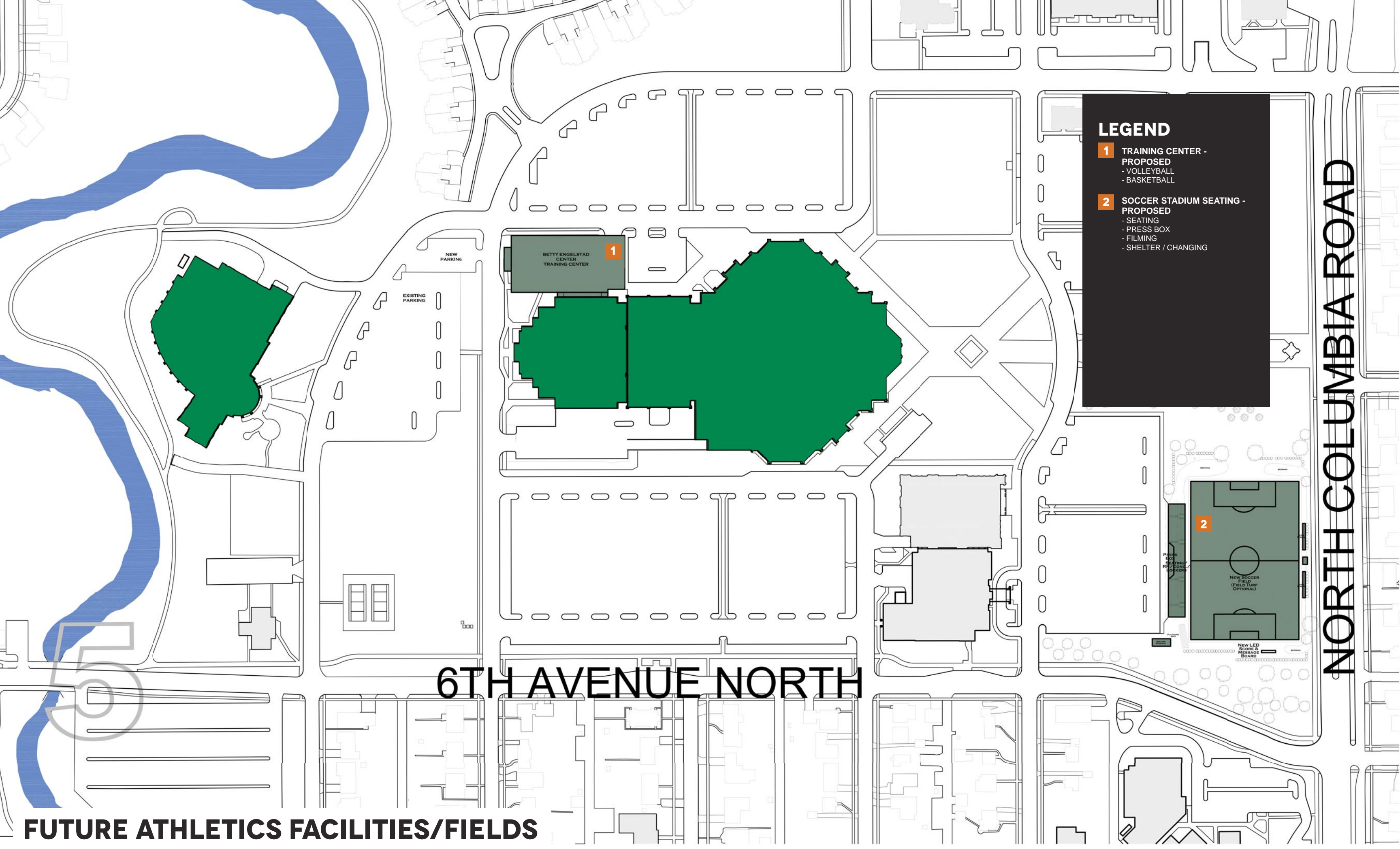
COLUMBIA ROAD

TUNNEL CONNECTION

EXISTING
HIGH PERFORMANCE
CENTER

UND TURF SPORTS - MASTERPLAN





FUTURE ATHLETICS FACILITIES/FIELDS



ATHLETICS CAMPUS

BRONSON CAMPUS

Summary

Located adjacent to campus, the Bronson Campus is home to Ralph Engelstad Arena, Betty Engelstad Arena, the Student Wellness Center, and along Columbia Road is where soccer games are currently held.

CENTRAL CAMPUS

Summary

The Central Campus of UND Athletics includes the Hyslop Sports Center, Memorial Stadium, and the High Performance Center. This location is one of the "Gateways" to the campus and is one of the areas the majority of people view when entering campus. The Central Campus host the majority of UND's sports practice, training, locker rooms and coaches offices areas. The area has sufficient parking with surface parking and the parking ramp.

OFF CAMPUS

Apollo Softball Complex

Softball

Choice Health & Fitness

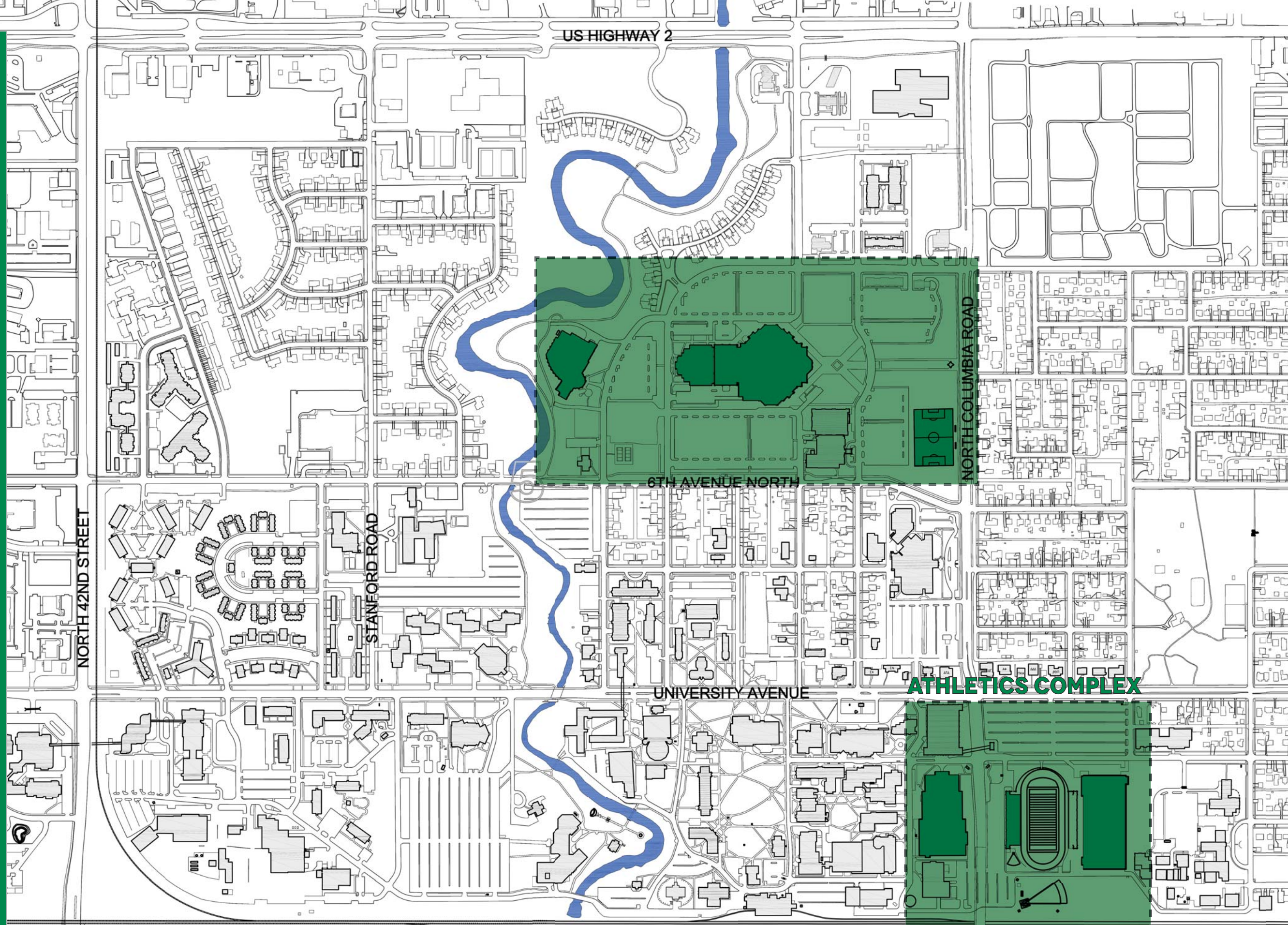
Men's Tennis

Women's Tennis

Kings Walk

Men's Golf

Women's Golf



US HIGHWAY 2

NORTH 42ND STREET

STANFORD ROAD

6TH AVENUE NORTH

NORTH COLUMBIA ROAD

UNIVERSITY AVENUE

DEMERS AVENUE

ATHLETICS COMPLEX

EXISTING ATHLETICS FACILITIES/FIELDS



CENTRAL CAMPUS

HYSLOP SPORTS CENTER

Building Summary-

Athletics Administration

Student Academics

Weights/ Training

Men's Track & Field (Offices and Lockerrooms)

Women's Track & Field (Office and Lockerrooms)

Softball (Offices and Lockerrooms)

Golf (Office and Hitting Simulator)

Swimming (Offices and Lockerrooms)

Recommendation: After inventory of current athletic department uses in Hyslop, it's determined Phase II of the UND High Performance Center as currently designed would need approximately 7,000 s.f. added to move all functions from Hyslop Sports Center. Hyslop would no longer be occupied by athletics and can be redesigned for future university needs.

MEMORIAL STADIUM

Building Summary-

Football – Locker Rooms

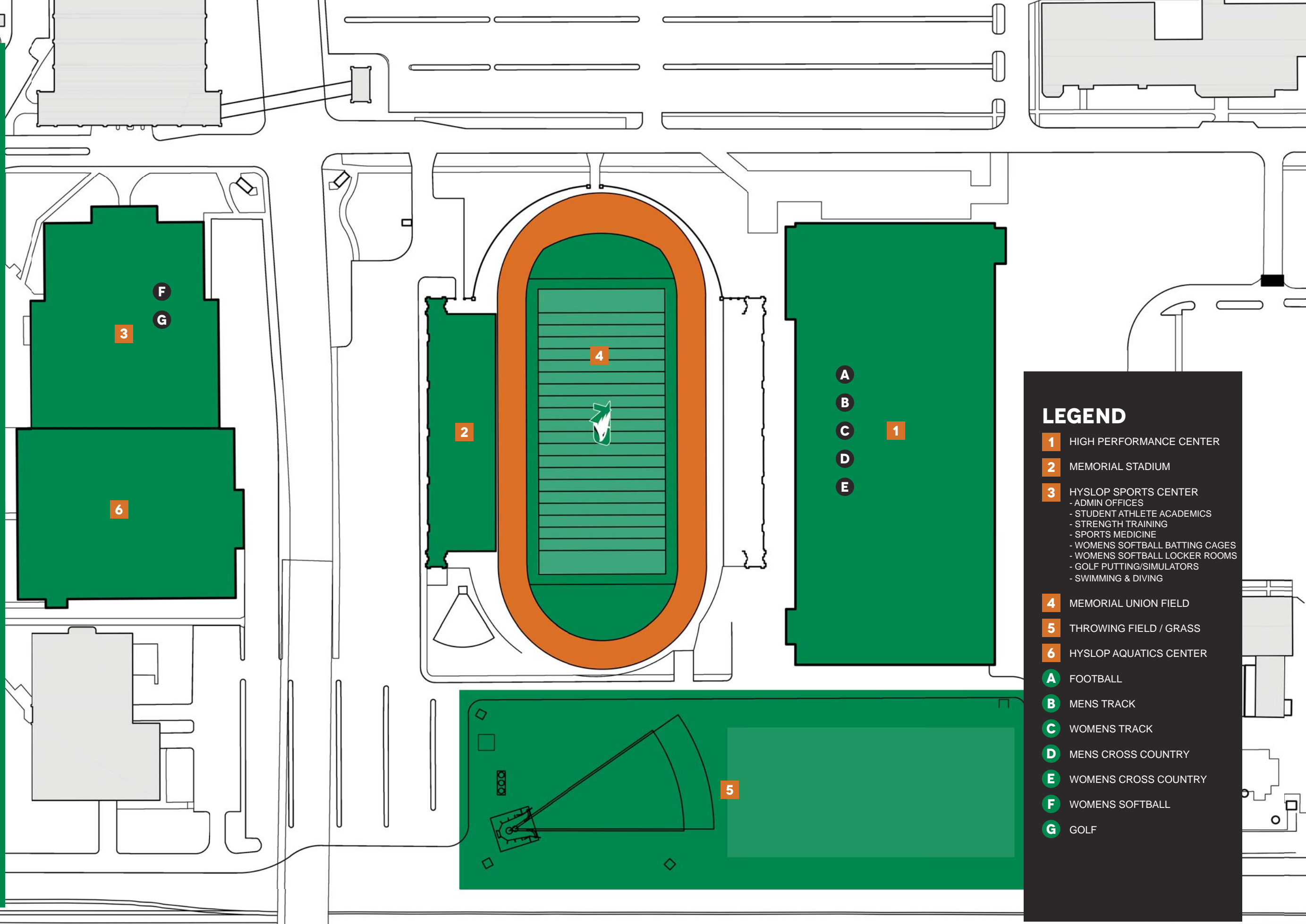
Recommendation: Phase II of the UND High Performance Center will have space allocated for the football team's locker rooms, training rooms, and coaches offices. Once Phase II of the UND High Performance Center is completed, Memorial Stadium will no longer be occupied by any athletics and can be redesigned for future athletic needs.

HIGH PERFORMANCE CENTER

Football

Men's Track & Field

Women's Track & Field

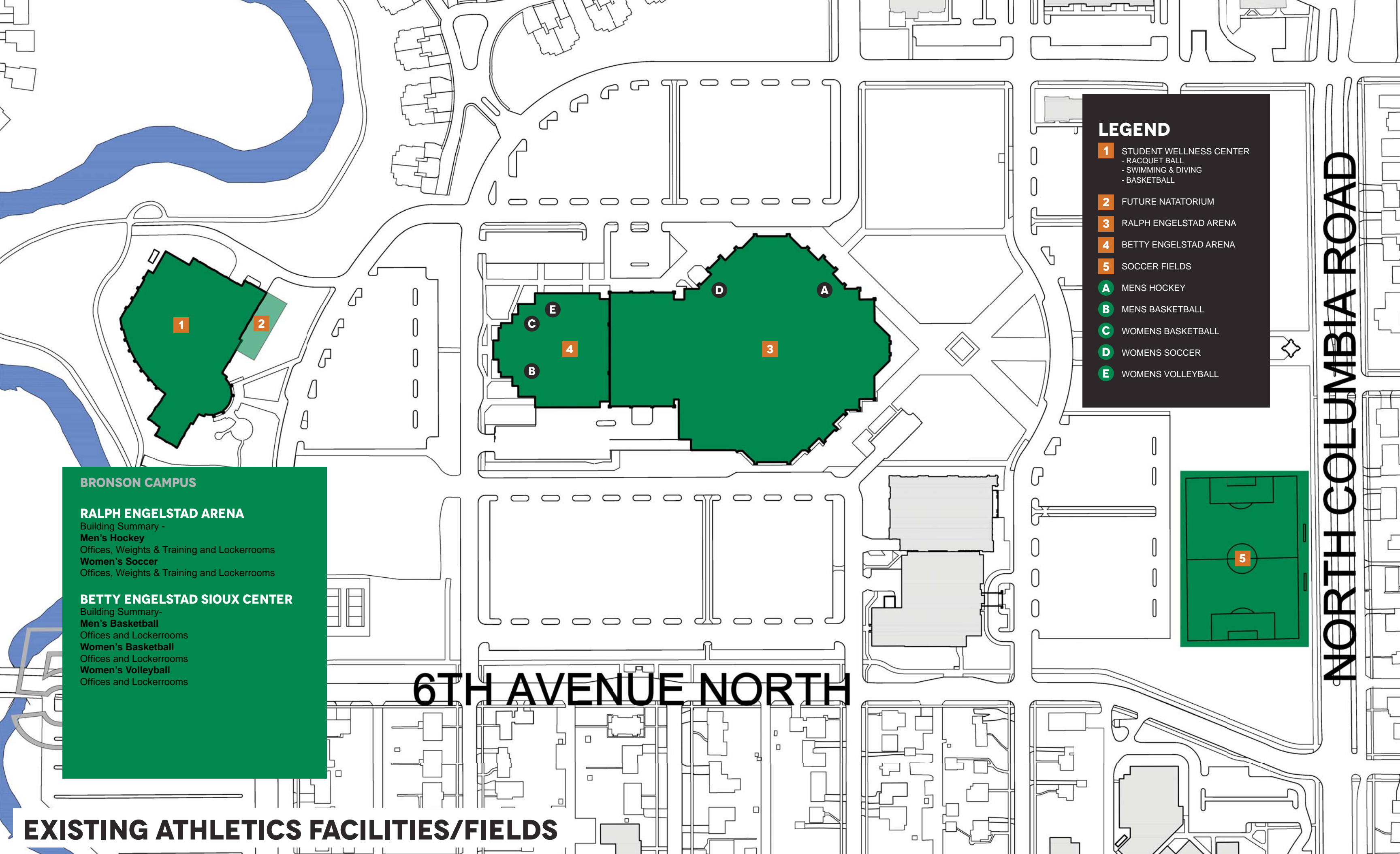


LEGEND

- 1** HIGH PERFORMANCE CENTER
- 2** MEMORIAL STADIUM
- 3** HYSLOP SPORTS CENTER
 - ADMIN OFFICES
 - STUDENT ATHLETE ACADEMICS
 - STRENGTH TRAINING
 - SPORTS MEDICINE
 - WOMENS SOFTBALL BATTING CAGES
 - WOMENS SOFTBALL LOCKER ROOMS
 - GOLF PUTTING/SIMULATORS
 - SWIMMING & DIVING
- 4** MEMORIAL UNION FIELD
- 5** THROWING FIELD / GRASS
- 6** HYSLOP AQUATICS CENTER
- A** FOOTBALL
- B** MENS TRACK
- C** WOMENS TRACK
- D** MENS CROSS COUNTRY
- E** WOMENS CROSS COUNTRY
- F** WOMENS SOFTBALL
- G** GOLF

EXISTING ATHLETICS FACILITIES/FIELDS





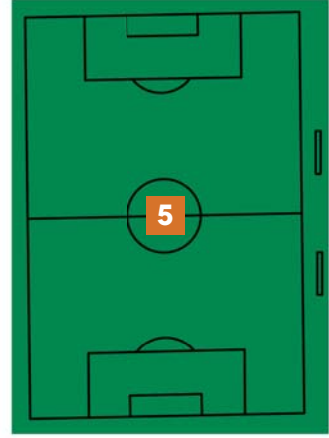
LEGEND

- 1** STUDENT WELLNESS CENTER
- RACQUET BALL
- SWIMMING & DIVING
- BASKETBALL
- 2** FUTURE NATATORIUM
- 3** RALPH ENGELSTAD ARENA
- 4** BETTY ENGELSTAD ARENA
- 5** SOCCER FIELDS
- A** MENS HOCKEY
- B** MENS BASKETBALL
- C** WOMENS BASKETBALL
- D** WOMENS SOCCER
- E** WOMENS VOLLEYBALL

BRONSON CAMPUS

RALPH ENGELSTAD ARENA
Building Summary -
Men's Hockey
Offices, Weights & Training and Lockerrooms
Women's Soccer
Offices, Weights & Training and Lockerrooms

BETTY ENGELSTAD SIOUX CENTER
Building Summary -
Men's Basketball
Offices and Lockerrooms
Women's Basketball
Offices and Lockerrooms
Women's Volleyball
Offices and Lockerrooms

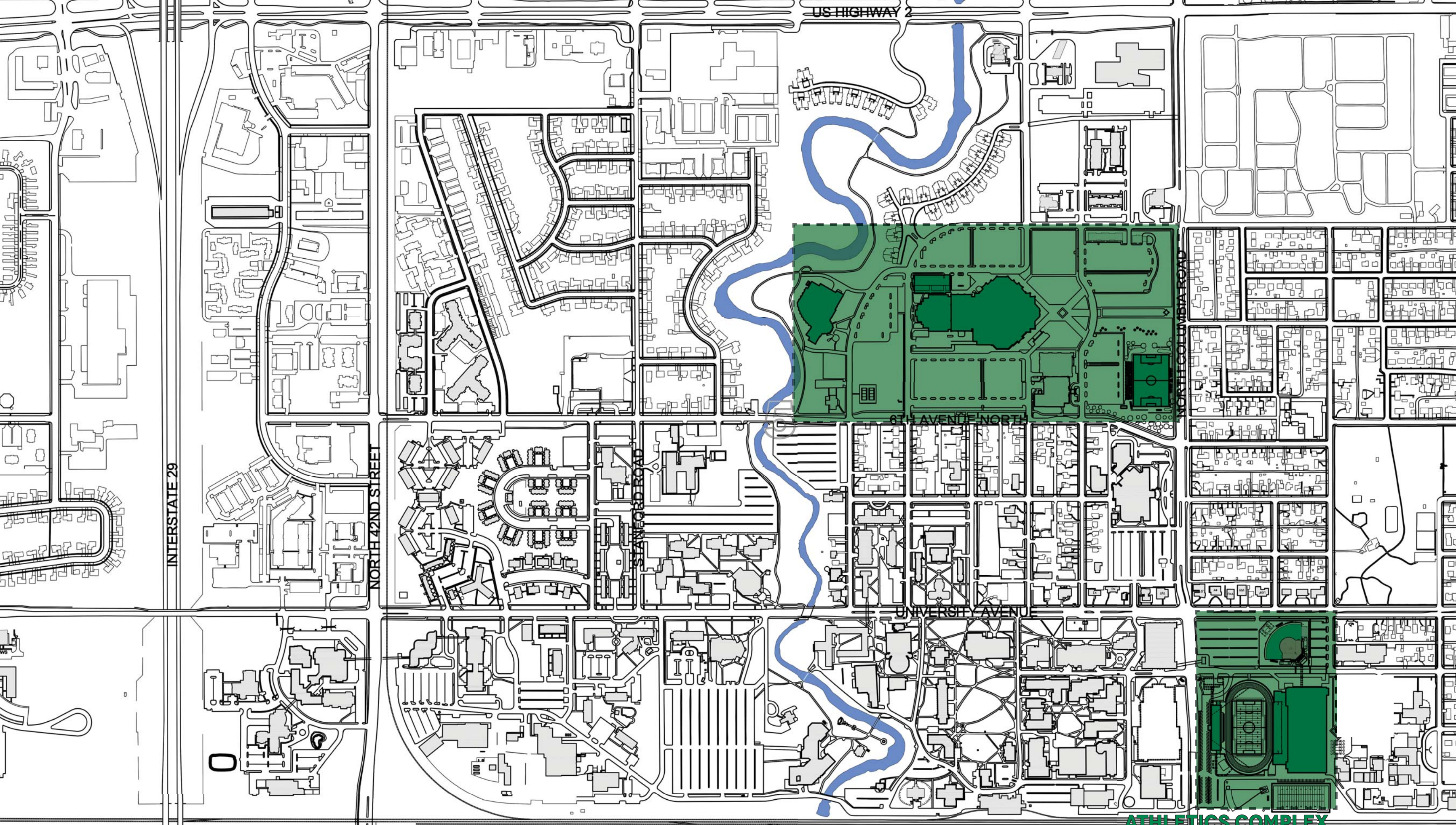


NORTH COLUMBIA ROAD

6TH AVENUE NORTH

EXISTING ATHLETICS FACILITIES/FIELDS





FUTURE ATHLETICS FACILITIES/FIELDS

UNIVERSITY OF NORTH DAKOTA ATHLETICS MASTERPLAN
GRAND FORKS, ND



RALPH ENGELSTAD ARENA

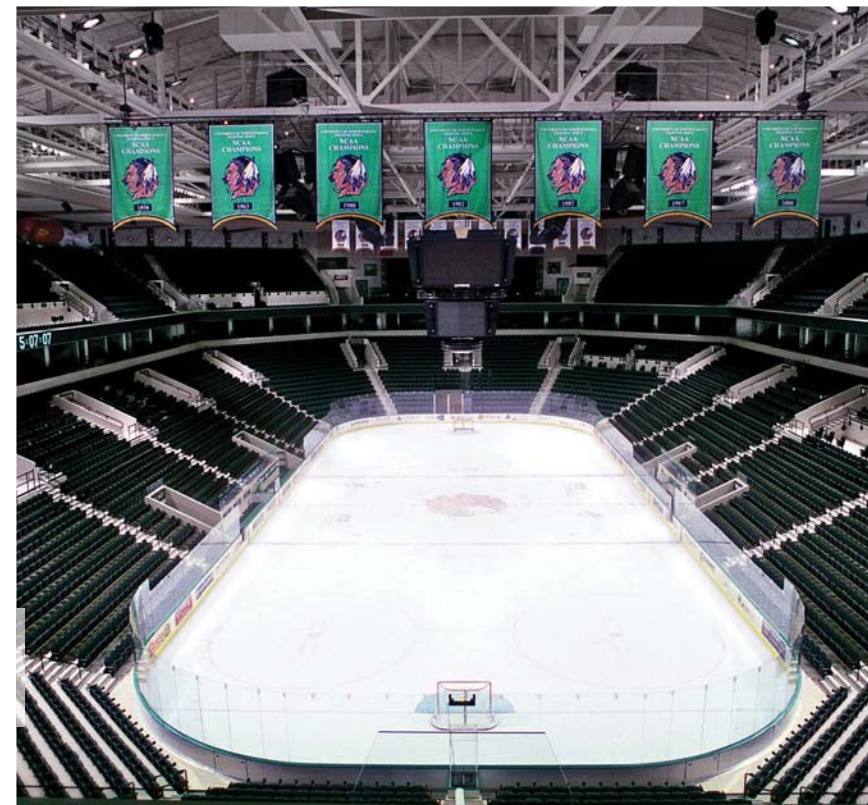
GRAND FORKS, ND



EXISTING FACILITY HOUSING MENS HOCKEY AND WOMENS SOCCER - NO FACILITY ENHANCEMENTS PROPOSED AT THIS TIME.

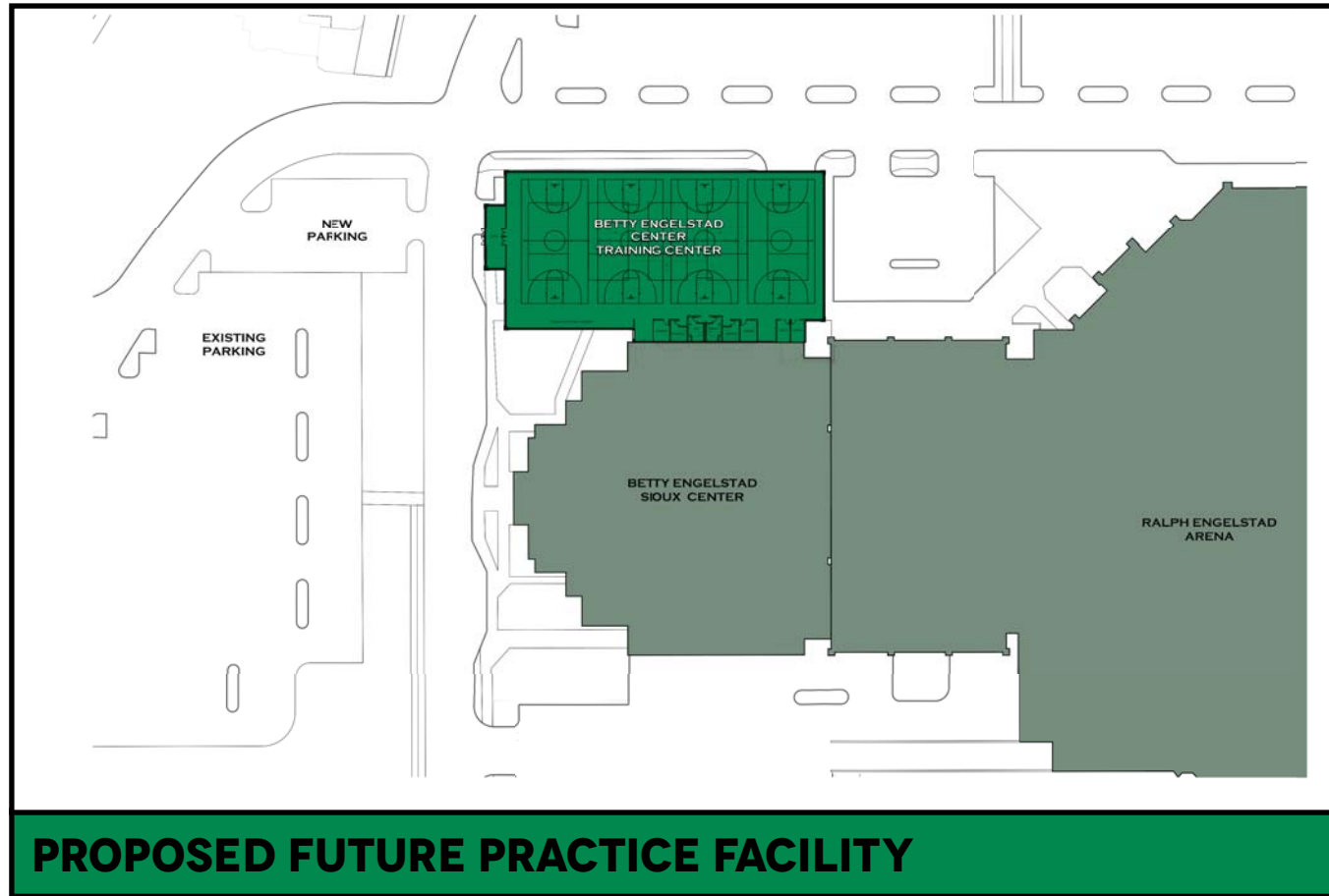
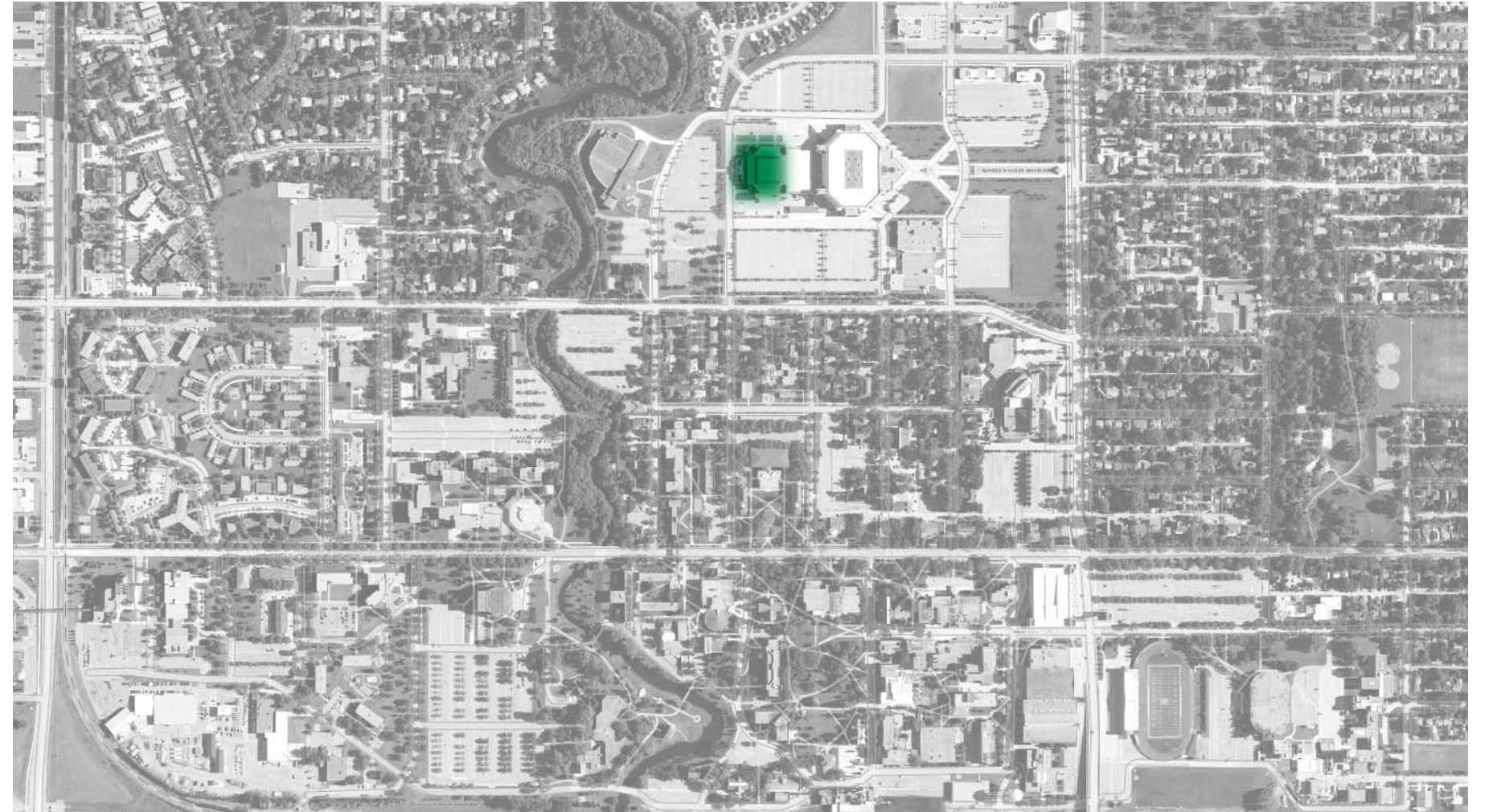
MENS         

WOMENS          



BETTY ENGELSTAD ARENA

GRAND FORKS, ND



BASKETBALL AND VOLLEYBALL TEAMS ENCOUNTERED PRACTICE TIME AND GAME TIME CONFLICTS DUE TO SHARING THE SAME GAME AND PRACTICE FACILITY CURRENTLY. UND ATHLETICS PROPOSED SOLUTION INCLUDES A PRACTICE ONLY FACILITY EXPANSION ADDING (4) FULL SIZE BASKETBALL COURTS (2 FOR WOMEN / 2 FOR MEN) TO BE USED FOR ANYTIME PRACTICE ACCESS.



HYSLOP SPORTS CENTER

GRAND FORKS, ND



HYSLOP SPORTS CENTER

Recommendation:

After inventory of current athletic department uses in Hyslop, it's determined Phase II of the UND High Performance Center as currently designed would need approximately 7,000 s.f. added to move all functions from Hyslop Sports Center. Hyslop would no longer be occupied by athletics and can be redesigned for future university needs.



MENS

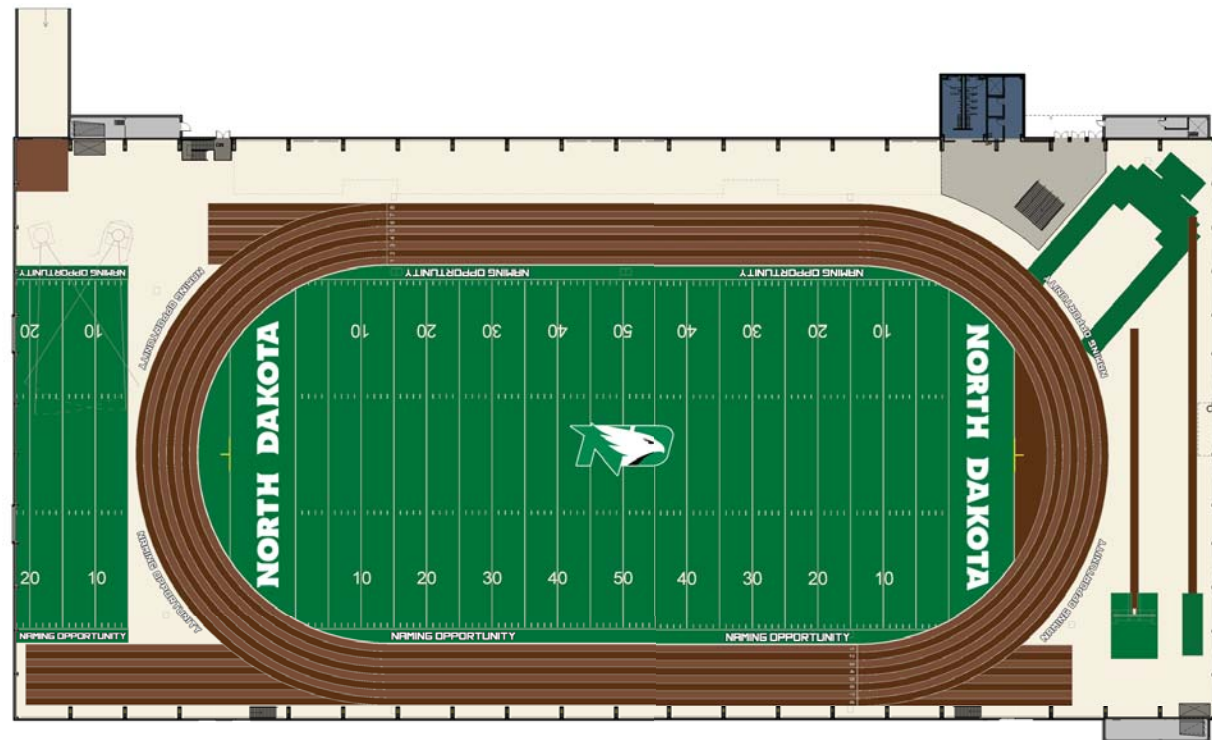


WOMENS



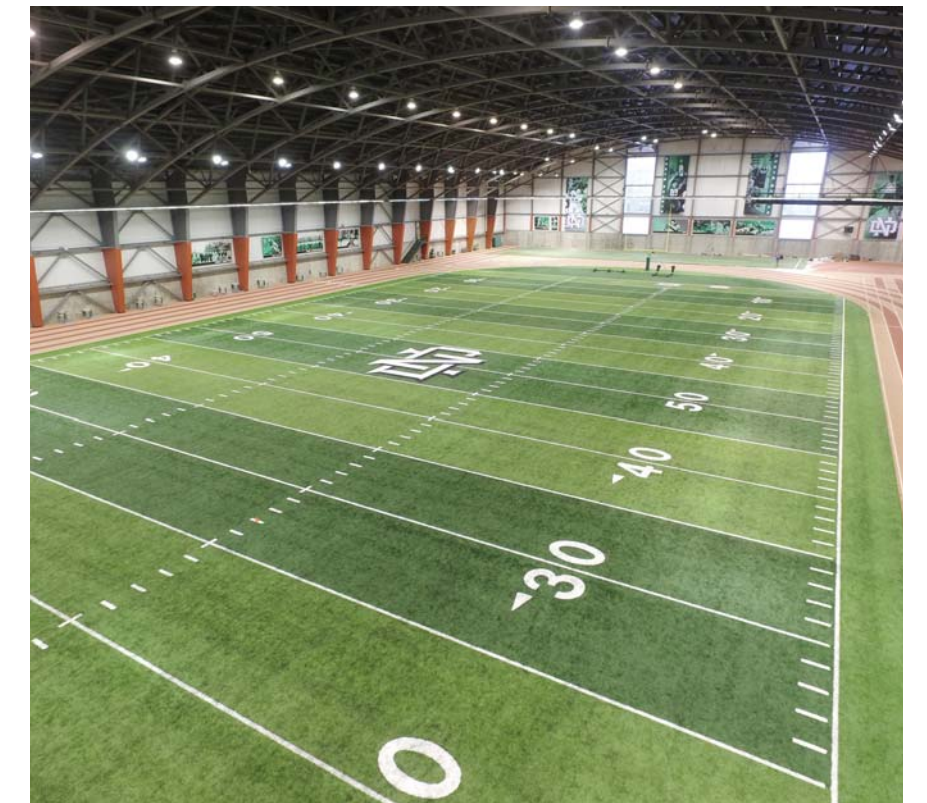
UND ATHLETICS HIGH PERFORMANCE CENTER- PHASE I

GRAND FORKS, ND



EXISTING FACILITY HOUSING TRAINING FOR ALL UND ATHLETICS SPORTS.

SPECTATOR SEATING BUILDOUT PENDING, OTHERWISE NO FACILITY ENHANCEMENTS PROPOSED AT THIS TIME.



UND ATHLETICS HIGH PERFORMANCE CENTER- PHASE II

GRAND FORKS, ND

HIGH PERFORMANCE CENTER II

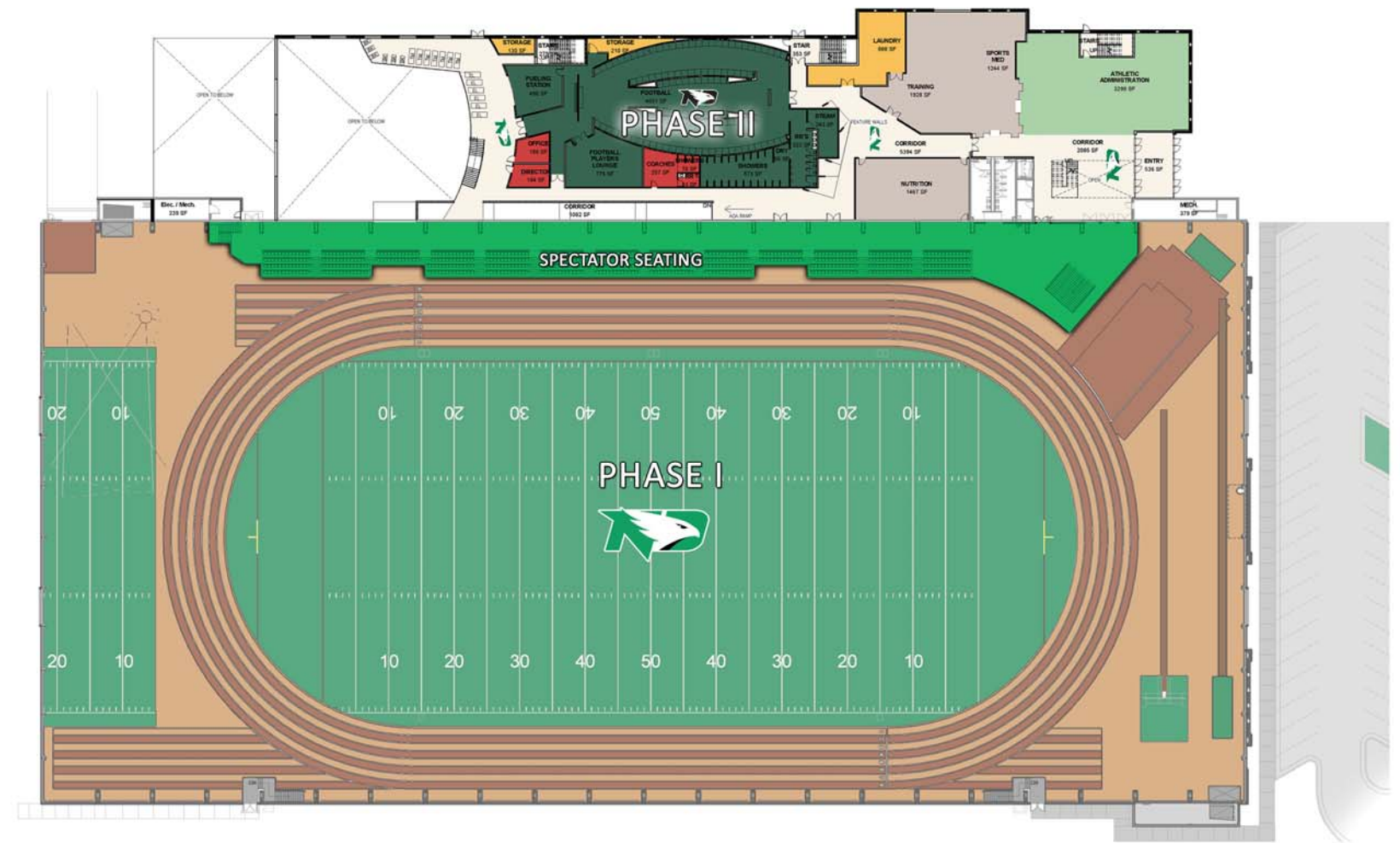
Proposed solution is to move forward with the planned addition to the High Performance Center project completed in 2014.

The addition would include the following solutions for the Athletic Department as whole as well as address many deficiencies with several individual sports.

- Weight room and strength training area with coaching and instruction.
- Nutrition center and fueling stations
- Training room facilities
- Sports Medicine - rehabilitation and orthopedics spaces.
- Academic and tutoring center
- Track and field locker rooms for men and women
- Cross country locker rooms for men and women
- Softball locker rooms
- Golf lockers, simulators, and green space
- Football locker room facility
- Athletic Administration offices
- Hall of history displays
- Restroom facilities and other support spaces.

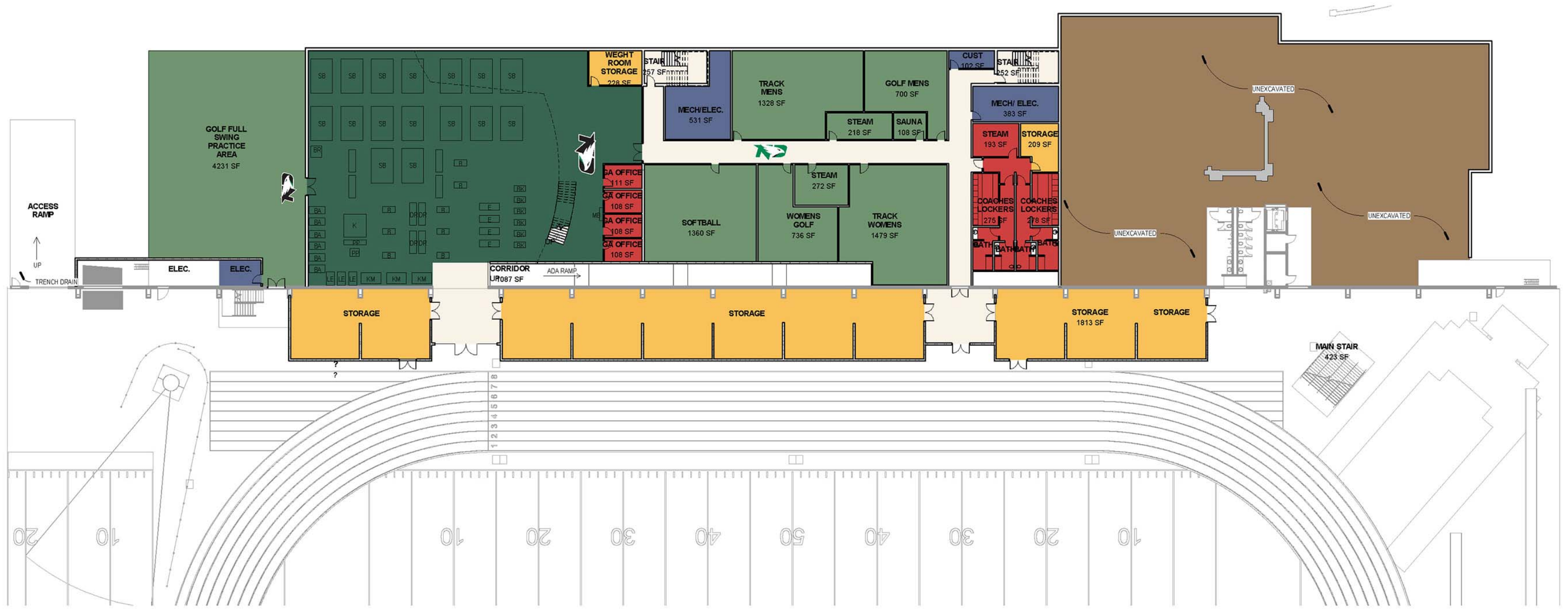
Exterior track and field replacement for training and practice.

Proposed facility of 100,000+- square feet to address these spaces needs.



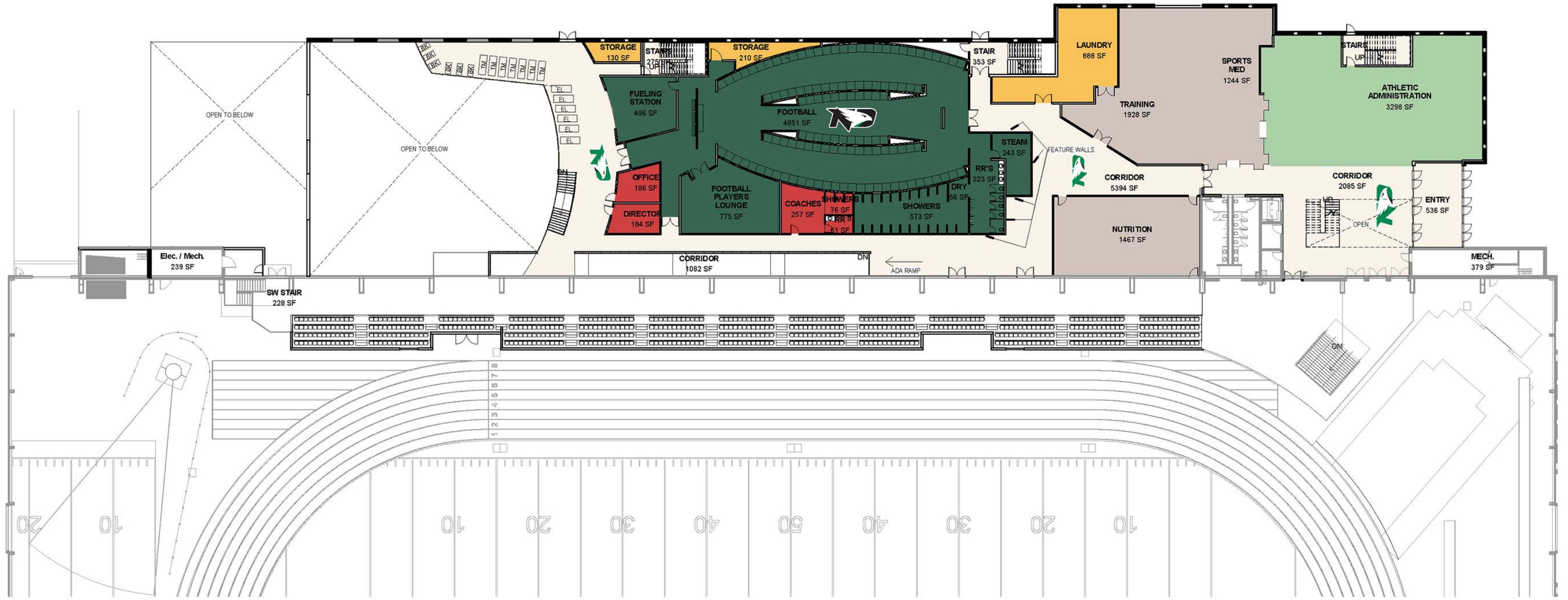
UND ATHLETICS HIGH PERFORMANCE CENTER- PHASE II

GRAND FORKS, ND



UND ATHLETICS HIGH PERFORMANCE CENTER- PHASE II

GRAND FORKS, ND

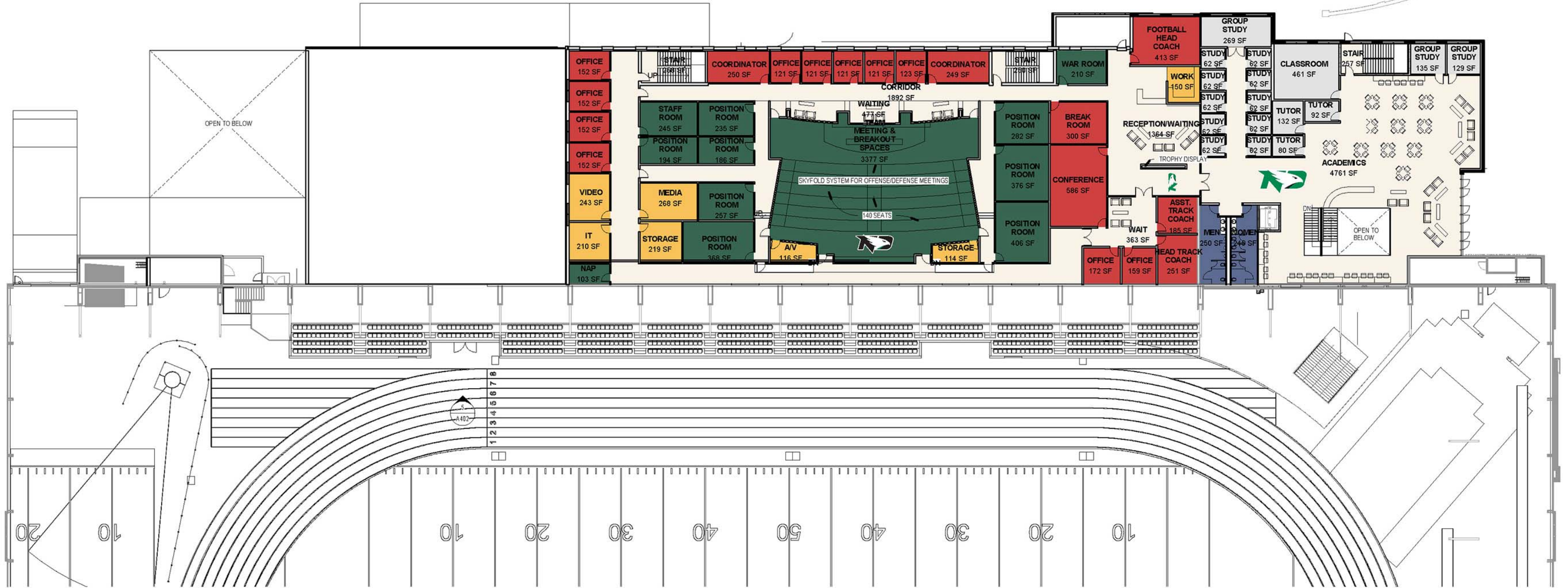


MAIN LEVEL



UND ATHLETICS HIGH PERFORMANCE CENTER- PHASE II






GRAND FORKS, ND

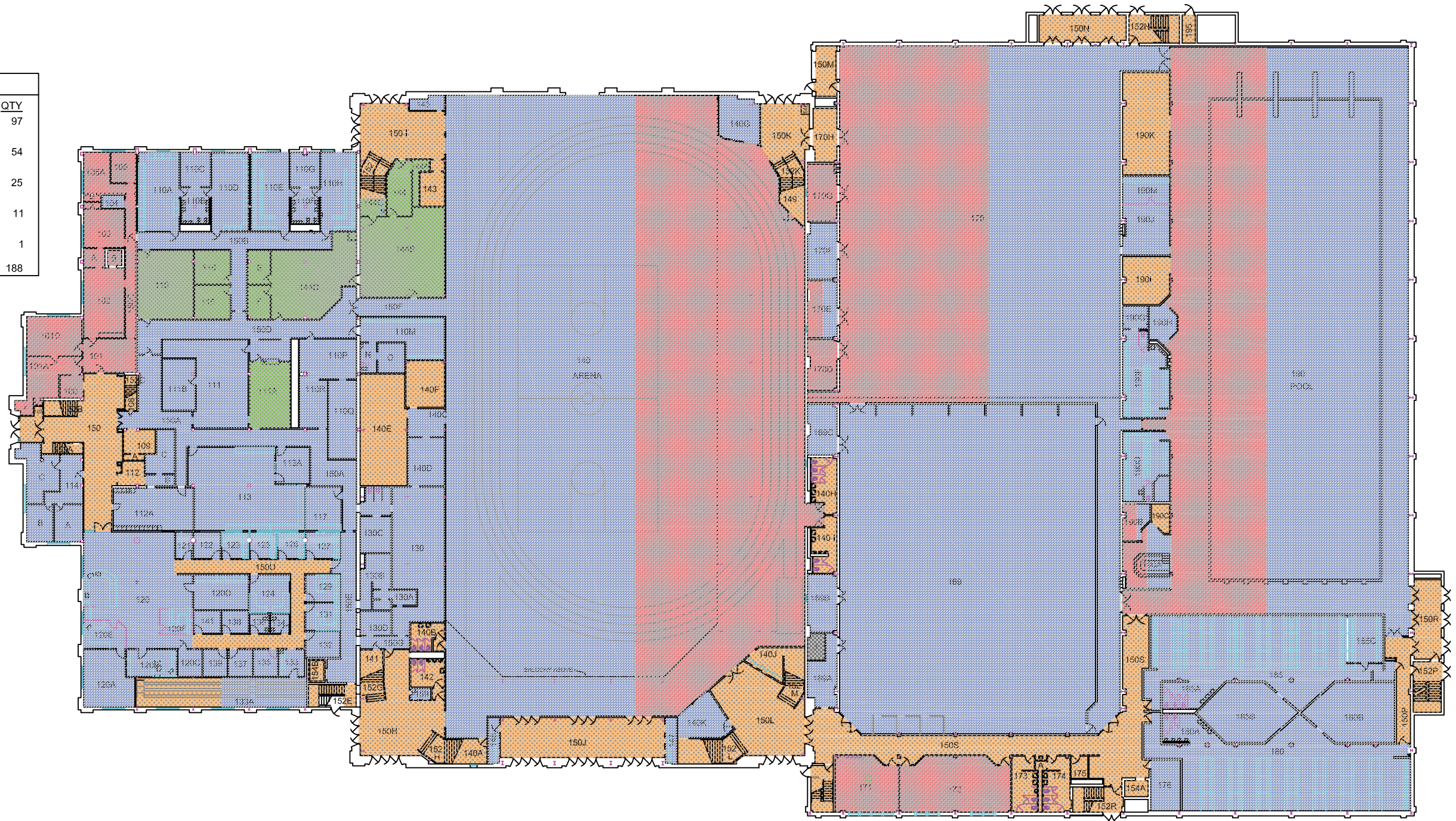


UPPER LEVEL

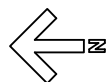




ALLOCATED GROUP		
	AREA	QTY
	ATHLETIC TOTAL	72,918 97
	FACILITIES MANAGEMENT	13,174 54
	KINESIOLOGY & PUBLIC HEALTH ED	24,846 25
	SPORTS MEDICINE	3,189 11
	TELECOMMUNICATIONS	56 1
TOTAL:		114,183 188



Hyslop Sports Center
 First Floor Plan
 Scale - 1"=35'

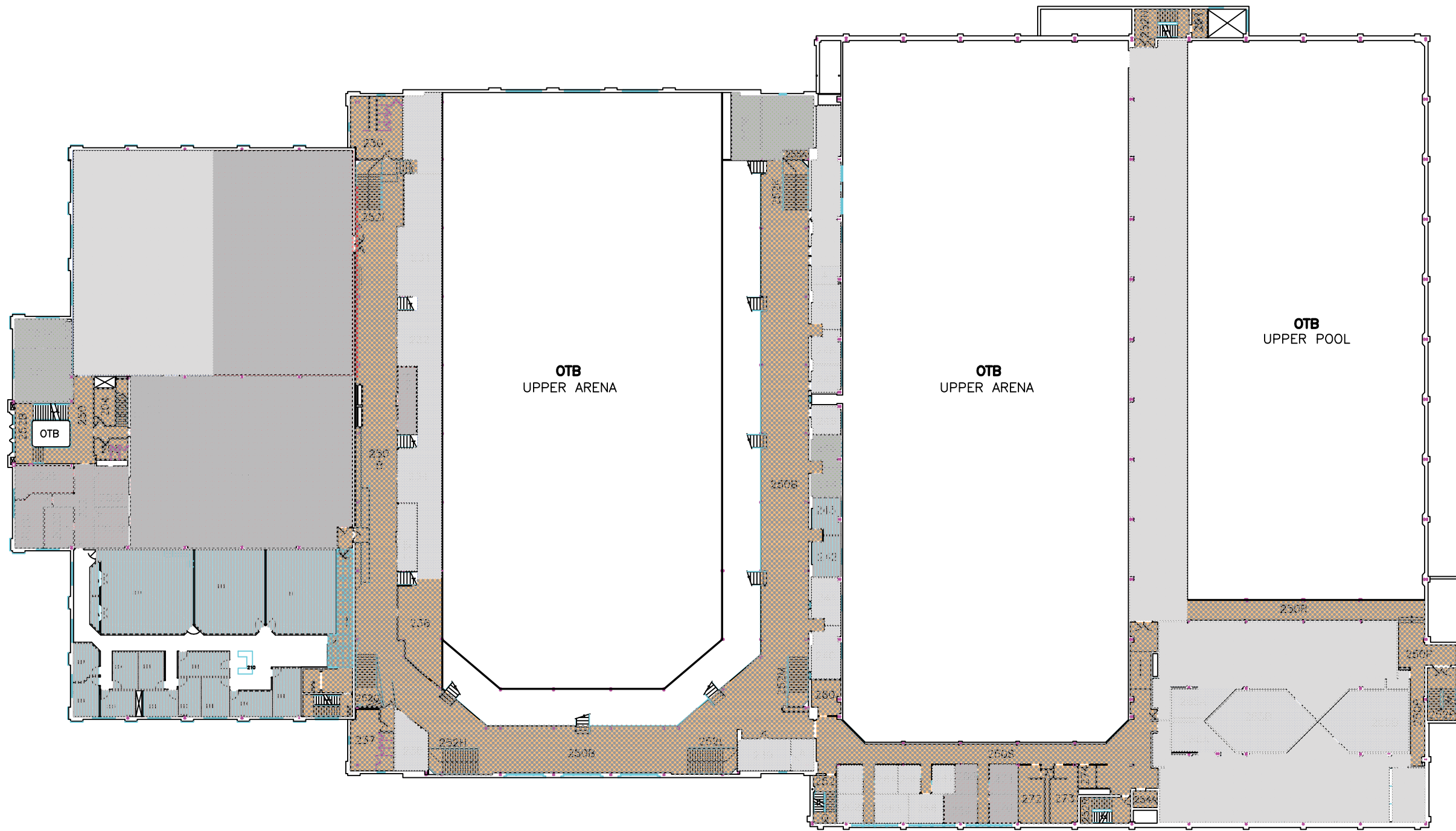


EXISTING INVENTORY REDUCTION


 University of North Dakota
 Building #24

EXHIBIT A





ALLOCATED GROUP		
	AREA	QTY
	ATHLETIC TOTAL	18,444 33
	FACILITIES MANAGEMENT	15,242 33
	KINESIOLOGY & PUBLIC HEALTH ED	10,186 14
	OCCUPATIONAL THERAPY	4,043 18
	SPORTS MEDICINE	1,339 6
	TOTAL:	49,254 104

EXISTING INVENTORY REDUCTION



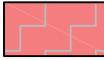
Hyslop Sports Center
 First Floor Plan
 Scale - 1"=35'

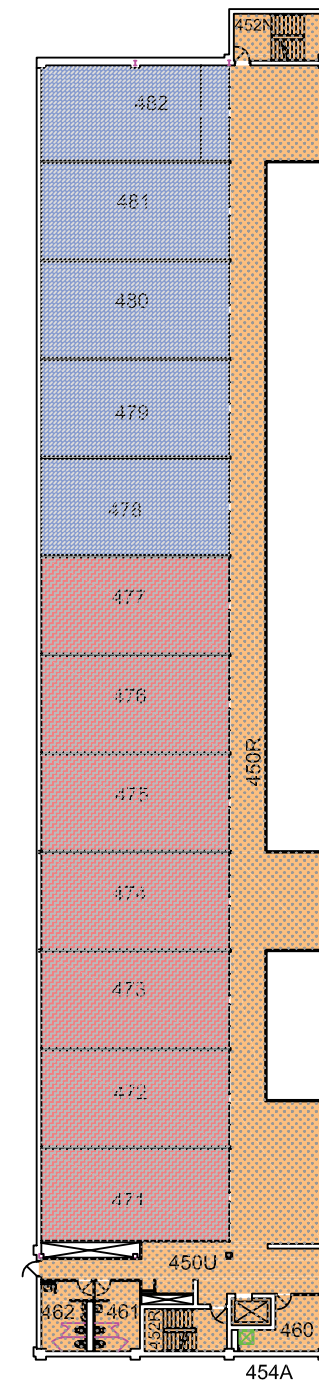


EXHIBIT B





ALLOCATED GROUP			
		AREA	QTY
	ATHLETIC TOTAL	4,089	5
	FACILITIES MANAGEMENT	4,053	8
	KINESIOLOGY & PUBLIC HEALTH ED	5,703	7
	TOTAL:	13,845	20



Hyslop Sports Center
Third Floor Plan
Scale - 1"=35'

EXISTING INVENTORY REDUCTION


University of North Dakota
Building #24

EXHIBIT D



UND Athletics Square Foot Comparison

	Proposed AHPC Phase II	Memorial Stadium	Hyslop	Memorial & Hyslop Combined	Total Difference
--	------------------------	------------------	--------	----------------------------	------------------

Football

Room Name	Square foot	Square Foot	Square Foot	Square Foot	Square Foot
-----------	-------------	-------------	-------------	-------------	-------------

Reception	1,512	240		240	1,272
Head Coach	426	228		228	198
Coaches	1,354	904		904	450
Grad Assistants	265		354	354	(89)
Offices	2,298			-	2,298
Conference	862	539		539	323
Position Meeting	2,708	1,144		1,144	1,564
Staff Room	444			-	444
Video Office	222	68		68	154
Nap Rooms	198			-	198
TBD Offices	874			-	874
Media Room	281			-	281
Team Meeting Auditorium	3,988	1,033		1,033	2,955
A/V	160			-	160
Team Meeting Storage	161			-	161
Team Meeting Waiting	523			-	523
Weight Room	9,577	525		525	9,052
Weight Room Storage	718	526		526	192
Weight Room RR's (MAW)	151			-	151
Weight Room Offices	387			-	387
Football Locker Room (Inc. Showers)	5,666	3,111		3,111	2,555
Coach's Locker Room (Inc. Showers)	770	282		282	488
Player Lounge	1,080			-	1,080
Player Fuling Station	928			-	928
Kitchen	354			-	354
Locker Room Equipment	616	521		521	95
Locker Room Storage	168	526		526	(358)
Equipment Manager	124			-	124
Laundry	510			-	510
Training Room	1,540	721	2,022	2,743	(1,203)
Rehab/ Sports Medicine	3,430			-	3,430
Recruiting	374			-	374
Nutrition Classroom	1,672			-	1,672
Under Bleacher Storage	4,121	7,922		7,922	(3,801)
Director Office	207			-	207
Office/ Kitchenette	172			-	172

Football Totals	48,841	18,290	2,376	20,666	28,175
------------------------	---------------	---------------	--------------	---------------	---------------

UND Athletics Square Foot Comparison

	Proposed AHPC Phase II	Memorial Stadium	Hyslop	Memorial & Hyslop Combined	Total Difference
--	------------------------	------------------	--------	----------------------------	------------------

Track & Field (Men's & Women's)

Head Coach	251		312	312	(61)
Coaches	514		352	352	162
Waiting	362			-	362
Mens Locker Room	1,280		737	737	543
Restroom/ showers	640		250	250	390
Steam/ Sauna	198			-	198
Women's Locker Room	1,280		528	528	752
Restroom/ showers	640			-	640
Steam/ Sauna	198			-	198
Players Lounge	1,050			-	1,050
Track Equipment	262		425	425	(163)
Mens Coaches Locker Room	850		508	508	342
Womens Coaches Locker Room	850		528	528	322

Track & Field Totals	8,375	-	3,640	3,640	4,735
---------------------------------	--------------	----------	--------------	--------------	--------------

EXISTING/ NEW COMPARISON CHARTS

EXHIBIT E



UND Athletics Square Foot Comparison

	Proposed AHPC Phase II	Memorial Stadium	Hyslop	Memorial & Hyslop Combined	Total Difference
--	------------------------	------------------	--------	----------------------------	------------------

Baseball

Head Coach			274	274	(274)
Locker Room (Inc. Showers)			1,032	1,032	(1,032)
Storage			276	276	(276)

Baseball Totals	-	-	1,582	1,582	(1,582)
------------------------	----------	----------	--------------	--------------	----------------

Softball

Head Coach	251		362	362	(111)
Locker Room (Inc. Showers)			599	599	(599)
Storage	1,050		761	761	289

Softball Totals	1,301	-	1,722	1,722	(421)
------------------------	--------------	----------	--------------	--------------	--------------

Swimming (Men's & Women's)

Mens Locker Room (Inc. Showers)			2,080	2,080	(2,080)
Womens Locker Room (Inc. Showers)			1,580	1,580	(1,580)
Swim Offices (Combined)			941	941	(941)
Swim Storage (Combined)			840	840	(840)
Pool			17,365	17,365	(17,365)
Mens Locker Room Pool Deck			2,929	2,929	(2,929)
Womens Locker Room Pool Deck			2,929	2,929	(2,929)
Pool offices			933	933	(933)
Swimming/ Diving Workout Space			1,640	1,640	(1,640)
Pool Seating			3,956	3,956	(3,956)
Pool Observation			2,182	2,182	(2,182)

Swimming Totals	-	-	37,375	37,375	(37,375)
------------------------	----------	----------	---------------	---------------	-----------------

UND Athletics Square Foot Comparison

	Proposed AHPC Phase II	Memorial Stadium	Hyslop	Memorial & Hyslop Combined	Total Difference
--	------------------------	------------------	--------	----------------------------	------------------

Volleyball

Storage			984	984	(984)
---------	--	--	-----	-----	-------

Volleyball Totals	-	-	984	984	(984)
--------------------------	----------	----------	------------	------------	--------------

Golf

Simulator			1,280	1,280	(1,280)
-----------	--	--	-------	-------	---------

Golf Totals	-	-	1,280	1,280	(1,280)
--------------------	----------	----------	--------------	--------------	----------------

Student Academics

Storage	3,429		2,848	2,848	581
Main Entry/ Lobby	550	367	960	1,327	(777)
Hall of Fame	3,760			-	3,760
Welcome/ Information	1,157		1,256	1,256	(99)
Mens Restroom	490	444	1,323	1,767	(1,277)
Womens Restroom	490	411	1,643	2,054	(1,564)
Study Rooms	804			-	804
Tutor Rooms	304			-	304
Group Study	265			-	265
Classroom	460		27,650	27,650	(27,190)
Academics (Class)	4,889			-	4,889

Student Academics Totals	16,598	1,222	35,680	36,902	(20,304)
---------------------------------	---------------	--------------	---------------	---------------	-----------------

Athletics Offices

Telecom			300	300	(300)
Mail Room			56	56	(56)
Offices			2,667	2,667	(2,667)
Conference Rooms			325	325	(325)
Break Room			88	88	(88)

Athletics Offices Totals	-	-	3,436	3,436	(3,436)
---------------------------------	----------	----------	--------------	--------------	----------------

EXISTING/ NEW COMPARISON CHARTS

EXHIBIT F



UND Athletics Square Foot Comparison

	Proposed AHPC Phase II	Memorial Stadium	Hyslop	Memorial & Hyslop Combined	Total Difference
--	------------------------	------------------	--------	----------------------------	------------------

Shared/ Remaining Space

Breakout/ Observation	2,655			-	2,655
Custodial	51	158	134	292	(241)
Weight Room Observation	1,568			-	1,568
Concessions	204			-	204
Mechanical	2,244	1,677	3,915	5,592	(3,348)
Electrical	608	64	297	361	247
Stairs	988	326	2,235	2,561	(1,573)
Elevator	62		100	100	(38)
Corridors/ Overlooks/ Concourse	23,062	1,256	53,421	54,677	(31,615)
Main Arena (old BB gym)			26,972	26,972	(26,972)
Weight Room			10,644	10,644	(10,644)
Weight Room Storage			590	590	(590)
Mult-purpose Gym			13,909	13,909	(13,909)
Hot tub			324	324	(324)
Sauna			107	107	(107)
2nd Floor Gymnasium			7,626	7,626	(7,626)
Mens Public Locker Room			2,929	2,929	(2,929)
Womens Public Locker Room			525	525	(525)
KPAG Wellness			206	206	(206)
Strength Coach			155	155	(155)
Cheer Team			199	199	(199)
Gynasium Seating			779	779	(779)
Main Arena Seating			17,774	17,774	(17,774)
Raquetball			5,740	5,740	(5,740)
Squash			820	820	(820)
Training			2,022	2,022	(2,022)

Shared/ Remaining Space Totals	31,442	3,481	151,423	154,904	(123,462)
---------------------------------------	---------------	--------------	----------------	----------------	------------------

Grand Totals	106,557	22,993	239,498	262,491	(155,934)
---------------------	----------------	---------------	----------------	----------------	------------------

EXISTING/ NEW COMPARISON CHARTS

EXHIBIT G

